

REVISIONS			
REV		DATE	APPROVED

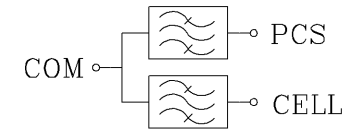
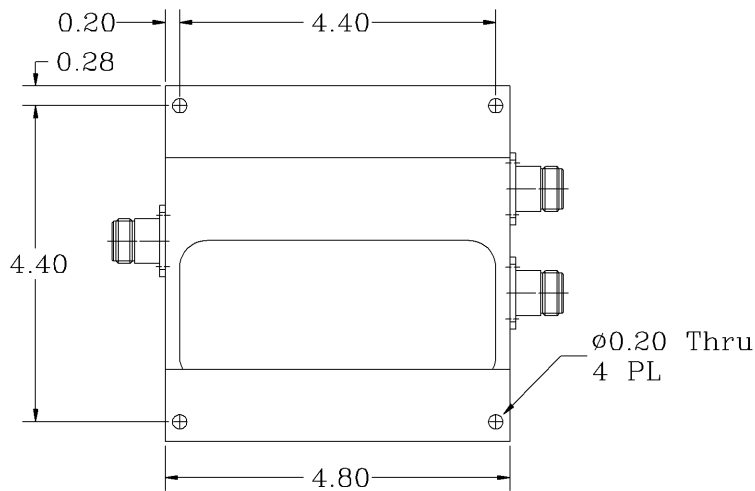
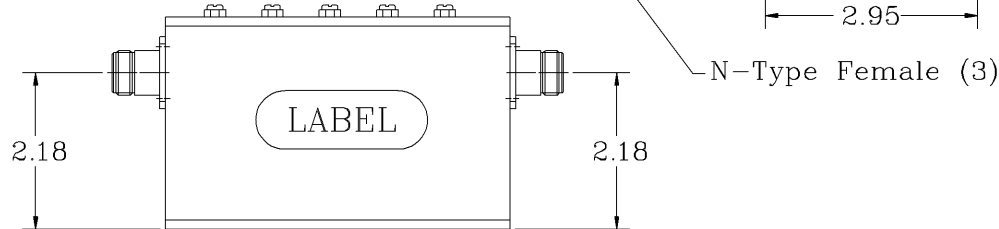
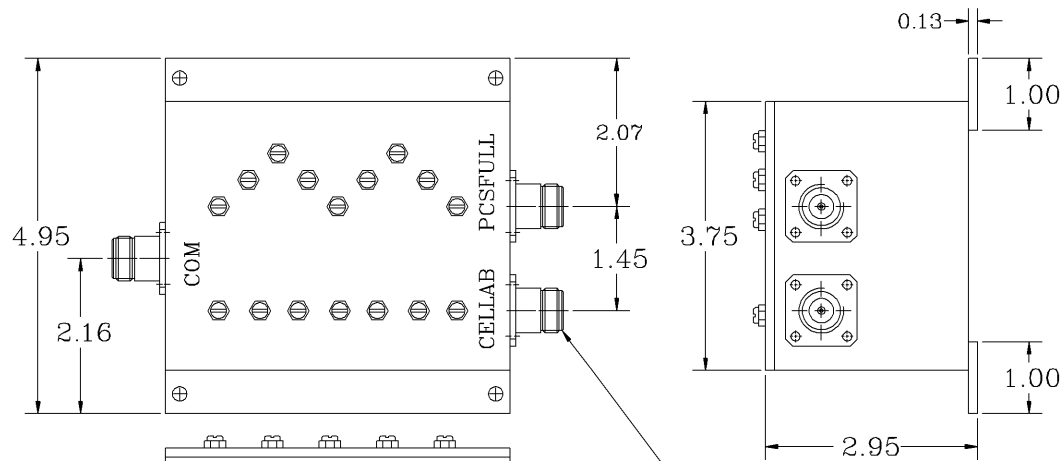

Electrical Specifications

- *CELL Pass Band Range [MHz] : 824 to 894
- *PCS Pass Band Range [MHz] : 1850 to 1990
- *Pass Band Insertion Loss [dB] : <0.3, 0.2 (Typ.)
- *Pass Band Ripple [dB] : < 0.5 P-T-P
- *Isolation Between filters [dB] : 65 (Min.)
- *Pass Band Return Loss [dB] : -18 (Max.), <1.3:1
- *Input/Output Impedance : 50 ohm
- *RF Power Capability CW each Channel : 150 Watts
PEAK : 1500 Watts
- *IM Products @ 2 x +43 dBm, IM3 [dBc] : < -135
- *Input/Output @ DC Ground Potential

OPERATING TEMPERATURE RANGE: -30°C TO +75°C

NOTES:

1. BREAK ALL CORNERS & EDGES.005/.010.
2. FINAL FINISH:
EPOXY GRAY - OPTIONAL

PROPRIETARY DOCUMENT:
THE CONTENTS OF THIS DOCUMENT WITH ALL INFORMATION AND PROCESSES ARE THE SOLE PROPERTY OF G-Way Microwave. THIS DOCUMENT MAY NOT BE DUPLICATED OR DISCLOSED TO ANY PARTY EXCEPT BY EXPRESSLY WRITTEN PERMISSION. THE ONLY AUTHORIZED USE OF THIS DOCUMENT BY A VENDOR IS FOR QUOTE PURPOSES AND SAID VENDOR AGREES NOT TO DISCLOSE ITS CONTENTS TO ANY THIRD PARTY. THIS DOCUMENT IS COPYRIGHTED 1996.

SKU # 98021059

DIMENSIONS ARE IN INCHES TOLERANCES ARE DECIMALS		CONTRACT NO:		G-Way Microwave	
ANGLES	DECIMALS	APPROVALS	DATE		
± 1"	X ± .05 XX ± .01 XXX ± .003	DRAWN	04/10	Combiner CELL/PCS CD859/1920HK-D4	
TREATMENT	CHECKED	ENG.	DESIGN ACTIVITY	SIZE	CAGE CODE
FINISH	63/			A	3K1H4
MATERIAL	AL6061-T6			DWG NO:	CD859/1920HK-D4-1
				SCALE	None
				SHEET	1 OF 1
				REV.	0