

REVISIONS			
REV		DATE	APPROVED

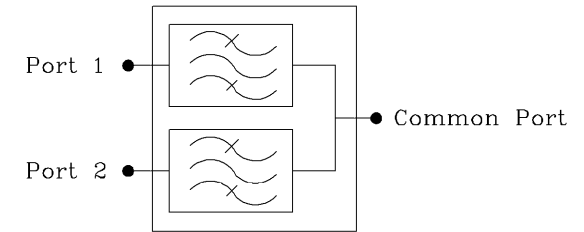
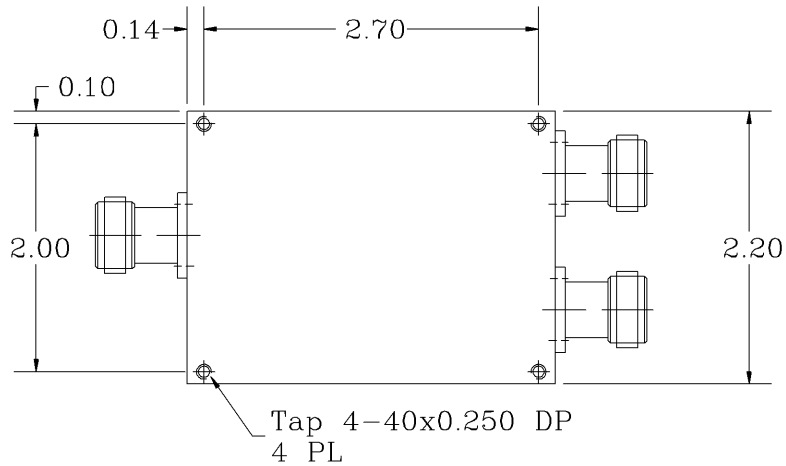
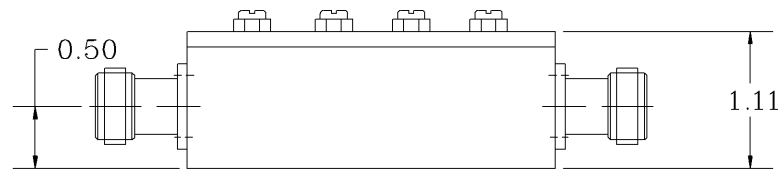
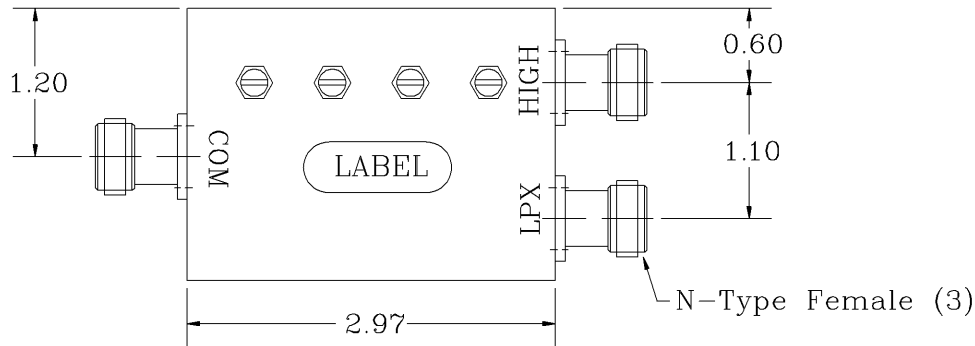

### Electrical Specifications

*LPX Frequency Range [MHz]	: DC to 900
*High Band Pass Frequency Range [MHz]	: 1710 to 2170
*LPX Insertion Loss [dB]	: 0.2 (Max.)
*High Pass Band Insertion Loss [dB]	: 0.5 (Max.)
*Pass Band Ripple [dB]	: < 0.2 P-T-P
*LPX Attenuation @ 1710 to 2170 MHz [dB]	: 45 (Min.), 50 (Typ.)
*High Band Attenuation @ DC to 900 MHz [dB]	: 60 (Min.), 65 (Typ.)
*Isolation between Filters [dB]	: 45 (Min.), 50 (Typ.)
*Input/Output Impedance	: 50 ohm
*Pass Band Return Loss [dB]	: -18 (Max.)
*Input Power Capability each Port [W]	: 30 Watt

OPERATING TEMPERATURE RANGE: -20°C TO +65°C

#### NOTES:

- BREAK ALL CORNERS & EDGES.005/.010.
- FINAL FINISH: EPOXY GRAY

PROPRIETARY DOCUMENT:  
THE CONTENTS OF THIS DOCUMENT WITH ALL INFORMATION AND PROCESSES ARE THE SOLE PROPERTY OF G-Way Microwave. THIS DOCUMENT MAY NOT BE DUPLICATED OR DISCLOSED TO ANY PARTY EXCEPT BY EXPRESSLY WRITTEN PERMISSION. THE ONLY AUTHORIZED USE OF THIS DOCUMENT BY A VENDOR IS FOR QUOTE PURPOSES AND SAID VENDOR AGREES NOT TO DISCLOSE ITS CONTENTS TO ANY THIRD PARTY. THIS DOCUMENT IS COPYRIGHTED 1998.

SKU # 98021026

DIMENSIONS ARE IN INCHES TOLERANCES ARE		CONTRACT NO:		G-Way Microwave	
ANGLES	DECIMALS	APPROVALS	DATE	TITLE Cross Band Combiner Cell/AWS	
± 1°	X ± .05 XX ± .01 XXX ± .003	DRAWN Segal	11/10	CD900/AWS/SK-B3	
TREATMENT	CHECKED	ENG.	DESIGN ACTIVITY	SIZE	CAGE CODE
FINISH 63/				A	3K1H4
MATERIAL				DWG NO:	REV.
				CD900/AWS/SK-B3-1	0
				SCALE None	SHEET 1 OF 1